

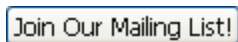

## Follow Us

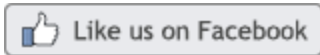

## Hot off the Presses!

Our Revised "Child Care Center Equipment & Furnishings Guide." This guide, originally published in July of 2005, is designed to help you with selecting furnishings and equipment that make your space...[Read More](#)

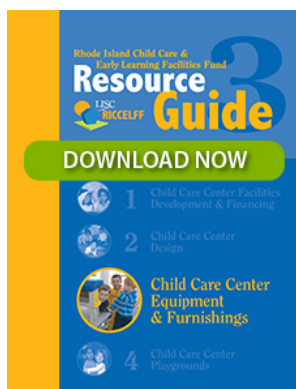

## About RICCELFF

The Rhode Island Child Care and Early Learning Facilities Fund (RICCELFF) is an innovative public-private partnership dedicated to expanding access to quality child care and early education opportunities throughout Rhode Island. The RICCELFF provides the capital and

## July 2015 eNews

### Facility Grant Informational Sessions to be held on August 13, 2015!

WAVE 4 of facility grant funding will launch at the end of August, 2015. Come learn more about this exciting opportunity. Informational sessions will cover the following topics:



- How to use the online application system
- Funding priorities - how to develop a competitive proposal
- Managing a federal grant - what will be required of you
- Time frames
- How to plan for and manage your project
- And more!

All sessions will be held on August 13, 2015 at the Rhode Island Community Food Bank, 200 Niantic Avenue, Providence, RI. [Click below to register.](#)

**SESSION I: August 13, 2015 at 9:00 am**

**SESSION II: August 13, 2015 at 11:00 am**

**SESSION III: August 13, 2015 at 1:00 pm**

**SESSION IV: August 13, 2015 at 3:00 pm**

## July's Question of the Month...

***Okay, I have a playground plan - now what?***

Having a playground plan developed that includes an audit of your existing playground space by a Certified Playground Safety Inspector will make your

technical expertise that child care and early learning centers need to improve the quality and capacity of their physical space. The RICCELFF provides a combination of training, resource materials, technical assistance, grant funding and flexible, affordable financing to support the creation of quality indoor and outdoor spaces. Click the logo below to learn more about how the RICCELFF can help your program.



capital grant request for funding to do work on your playground space much more competitive...[Read More](#)

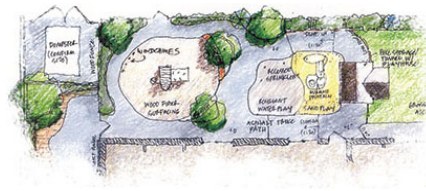

## CENTER SPOTLIGHT!

### *YMCA Heritage Park*

With the implementation of the 2013 DCYF regulations, two classrooms at the YMCA Heritage Park Early Learning Center were deemed non-compliant due to a complete absence of natural light. These two rooms were then closed and the license capacity was reduced by 40 preschool children...[Read More](#)



LISC, 146 Clifford Street , Providence, RI 02903

[SafeUnsubscribe™](#) {recipient's email}

[Forward this email](#) | [Update Profile](#) | [Customer Contact Data Notice](#)

Sent by [riccelff@lisc.org](mailto:riccelff@lisc.org)