



Building Exterior

Child & Family, a non-profit organization whose mission is to strengthen individuals, families and the communities in which they live operates programs throughout Rhode Island. For years, Child & Family has operated a successful high quality early learning center in Middletown, RI. While this center provides essential services to that community, services are lacking for the families they serve in their Providence location.

Child & Family operates programming from a space in the heart of Providence in a brick office building they own. The building, while ideally located, is not being optimized in its use. With an eye on mission and community need, Child & Family is exploring ways to take advantage of that space, including reconfiguring for use as an early learning center.

By Child & Family exploring the current use of their oversized brick office building with the help of an architect experienced in early learning design, they have developed a proposed plan that can potentially add a total of 132 children from infant to school age in this prime Providence location. This is a great use of space in a location that is starved for high quality, affordable care.

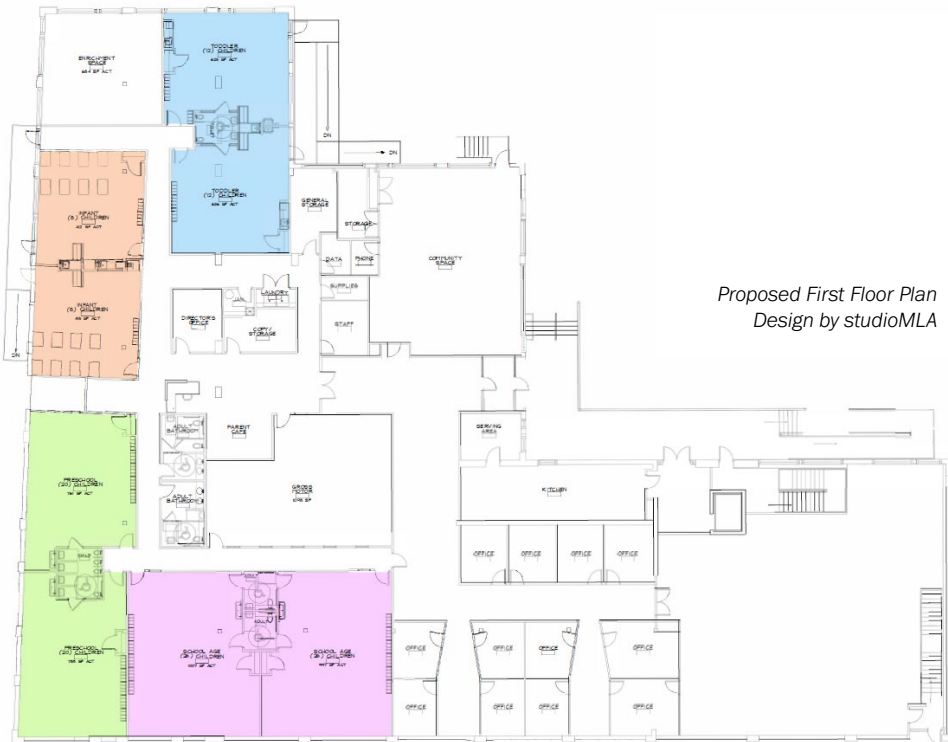

Proposed First Floor Plan
Design by studioMLA



Interior - Existing



Interior - Existing

PROJECT DETAILS

Year Completed	Not complete, conceptual only
Construction Type	Interior renovation
Estimated Development Cost	\$2,049,185
Square Footage	11,845 SF
# of Children	128
# of Classrooms	4 infant/toddler classrooms 2 preschool classrooms 2 school age classrooms
Construction Cost/Child	\$16,009/child
Construction Cost/SF	\$173/SF



Interior - Existing